

HAMRICK ART CENTER SENSORY MAP GADDY-HAMRICK
ART CENTER SENSORY MAP GADDY-HAMRICK
SENSORY MAP GADDY-HAMRICK ART CE
P GADDY-HAMRICK ART CENTER SENS
MRICK ART CENTER SENSORY MAP GA
ART CENTER SENSORY MAP GADDY-HAMRICK
SENSORY MAP GADDY-HAMRICK ART CE
P GADDY-HAMRICK ART CENTER SENS
MRICK ART CENTER SENSORY MAP GA
ART CENTER SENSORY MAP GADDY-HAMRICK



TABLE OF CONTENTS

Welcome & Introduction	2
Room Directory	3
Key of Sensory Icons	4
First Floor	5
Second Floor	7

WELCOME & INTRODUCTION

The intention of this sensory map is to promote inclusivity and accessibility within Gaddy-Hamrick Art Center at Meredith College, which includes Frankie G. Weems Gallery. Please use this map to take advantage of our resources and guide your unique experience. The Art Center offers free ADA-compliant parking, a curb cut leading to the entrance of the building, automatic doors, an elevator, a wheelchair accessible restroom, and a visual schedule. We also welcome service dogs.

We believe there is always room for progress and change; we will continue to make necessary updates and offer a safe space that celebrates diverse work and welcomes all visitors with ease and comfortability into our building and gallery.

To request accommodations for current exhibitions, please contact the Gallery Director at gallery@meredith.edu.

ROOM DIRECTORY

FIRST FLOOR

- 112** - Prof. Shannon Johnstone
- 113** - Prof. Woody Holliman and Prof. Dana Lovelace
- 114** - Computer Lab
- 119** - Seminar Room
- 122** - Photography Room
- 123** - Lighting Studio
- 124 & 125** - Teauge Digital Photography Lab
- 126** - Computer Lab
- 129** - 3D Design/Craft Studio
- 130** - Multimedia Studio
- 131** - Ceramics Studio
- 132** - Residential Artist Studio
- 133** - Glaze Room
- 134** - Ceramic Storage
- 135** - Kiln Room
- 137** - Auditorium
- 138** - Faculty Lounge
- 140** - Frankie G. Weems Gallery
- 142** - Gallery Director & Prof. Todd Jones
- 143** - Prof. Holly Fischer
- 144** - Slide Library

SECOND FLOOR

- 201** - Prof. Gregory Carter
- 202** - Prof. Sherry Difilippo & Prof. Lisa Pearce
- 205** - Prof. Emily Howard & Prof. Cameron Johnson
- 206** - Drawing and Art Education
- 208** - Fibers & Printmaking Studio
- 209** - 2D Design Studio
- 210** - Painting Studio

KEY OF SENSORY ICONS



Loud/ Low Noise Level



Braille



Restrooms/ Handicap Restroom



Low Vision



Bright/ Dim Lighting



Hard-of - Hearing



Elevator



Stairs



Strong Smell



Emergency Exit



Audio Description



Fire Extinguisher // Emergency Pulldown

FIRST FLOOR

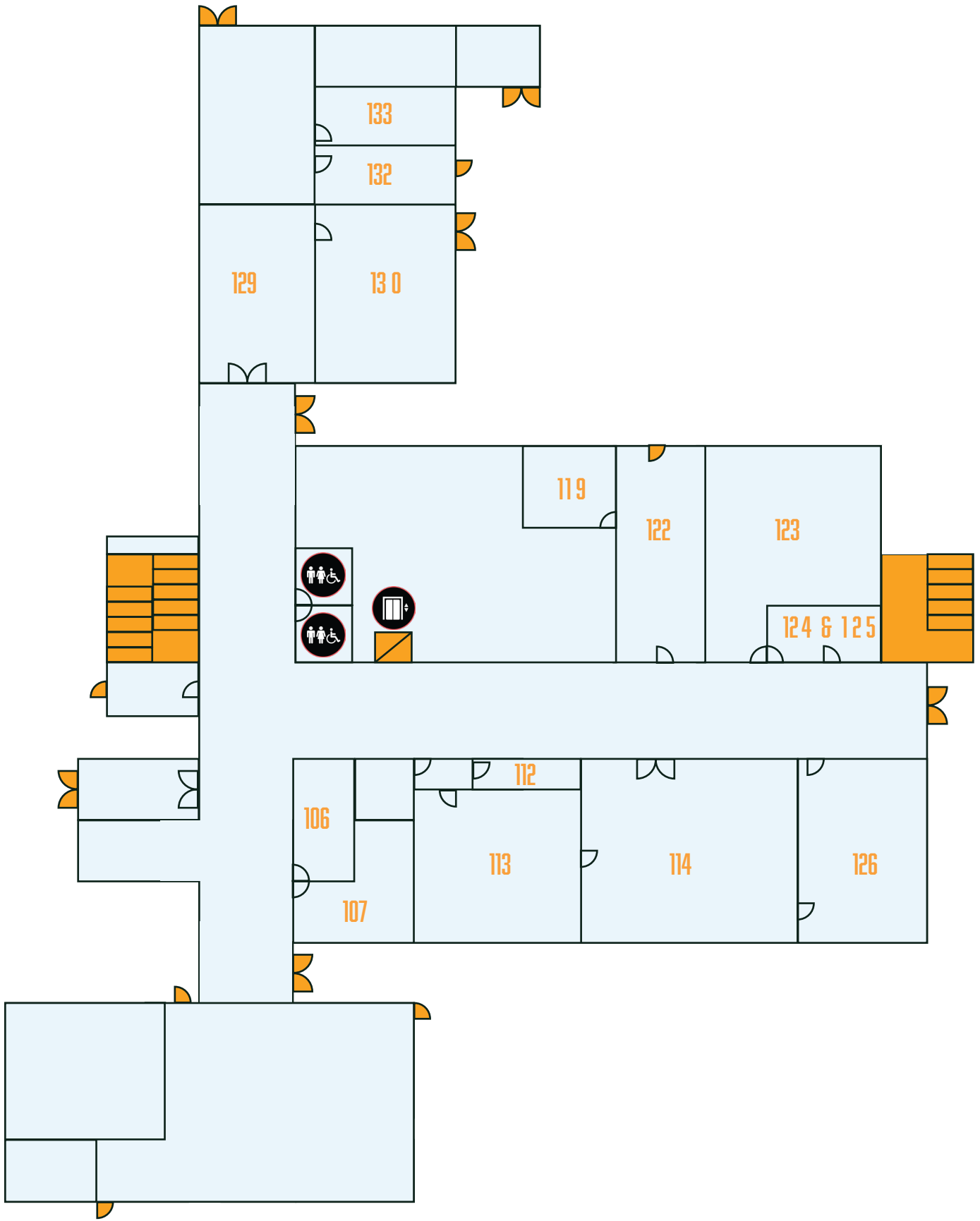

FIRST FLOOR



Room 129 & 131 are ceramic studio spaces and are frequently loud and crowded. The Frankie G. Weems Gallery is a designated quiet area, unless noted otherwise.



The female bathroom on the first floor is wheel-chair accessible. The entry door may be heavy when closed. Please alert staff for assistance.



The ceramics studios (room 129 and 131) work with clay and glaze, and as such are often strongly scented.



The department provides Braille labels for the number assigned to each room; this signage is located to the right or left of each door-frame. There is no description of the room's purpose provided in Braille. We do offer Braille labels within the Frankie G. Weems Gallery for our rotating exhibits.



Doors marked orange indicate fire exits. The stairs are marked in orange as well, and can be found at the front and back of the building. Our elevator- marked on the map- is across from office 106.

SECOND FLOOR



Rooms 208, 209, and 210 are studio spaces, and are frequently loud and crowded.



The upstairs bathrooms are not wheelchair accessible.



The painting studio (room 210) and the fibers studio (room 208) house a variety of dyes and paints. This results in strong and possibly dizzying scents.

SECOND FLOOR

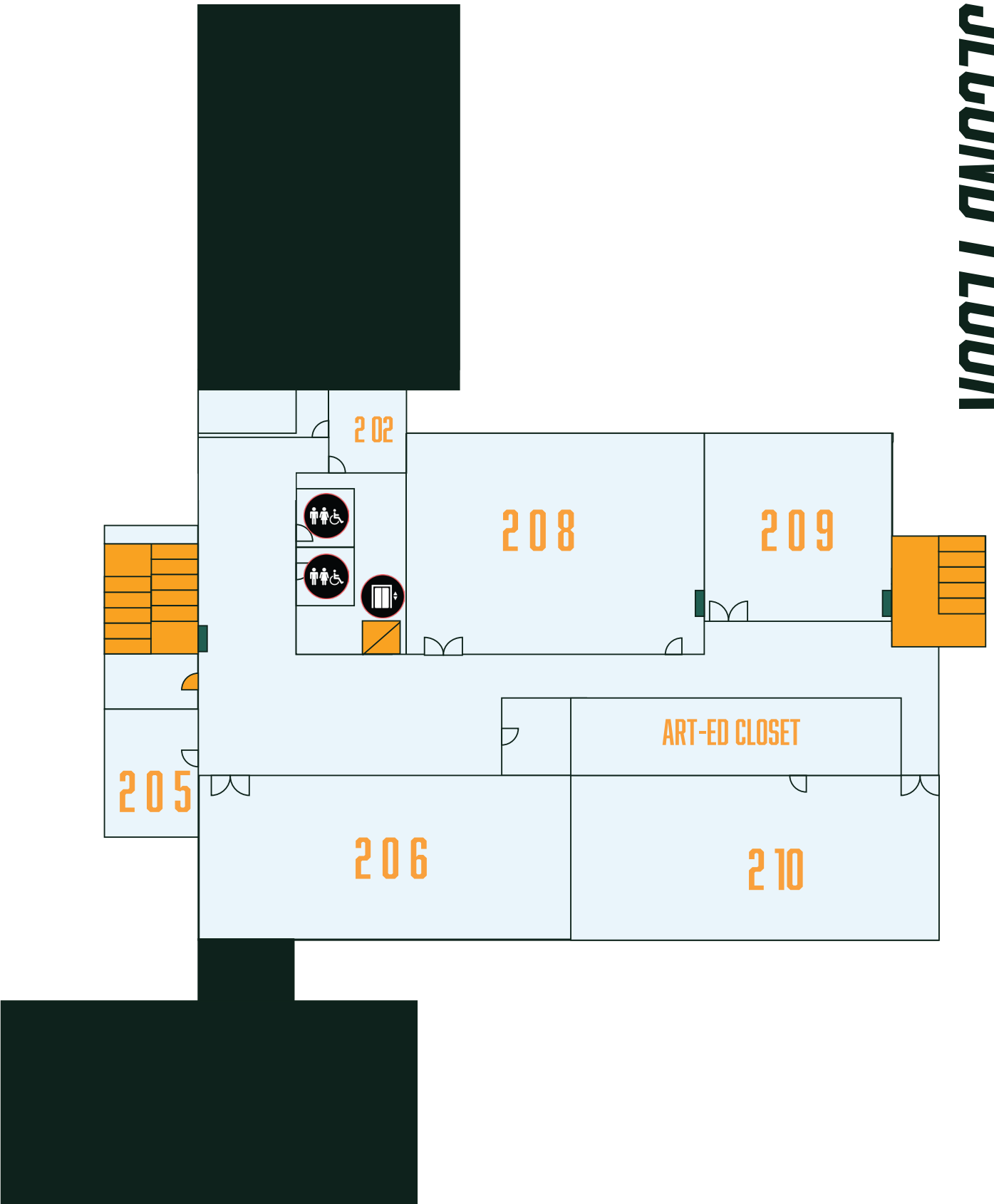

For further information or to request an accommodation, please
contact the Gallery Director at gallery@meredith.edu.

Gaddy-Hamrick Art Center
Meredith College
3800 Hillsborough Street
Raleigh, NC 27607

MEREDITH COLLEGE | ART GALLERIES